

Wheel Torque Transducer

Models TW15.0

- 7000 lb-ft capacity
- Adapts to 15" and larger wheels
- Environmentally protected
- Temperature compensated
- Rugged stainless steel construction
- Consistent sensitivity among all units
- Configured to reduce magnetic sensitivity

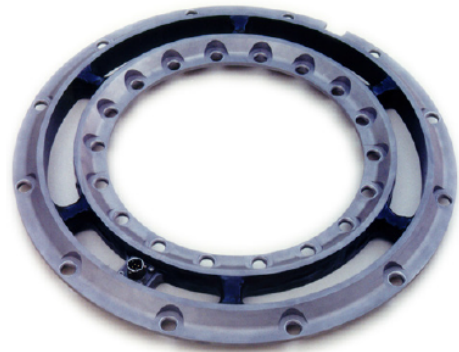

Description

Michigan Scientific's *TW15.0 Wheel Torque Transducer* is ideal for measuring wheel torque on both light and medium duty trucks. Designed to attach to adapters that simulate production wheel rims, this unit provides one channel of torque data. The adapter system is fabricated by generating a profile of the original wheel rim and designing a hub adapter and rim adapter that duplicate the critical dimensions of the original rim. The hub adapter fastens to the interior bolt circle of the torque transducer, and the rim adapter fastens to the exterior bolt circle. The versatility of this system allows the torque transducer to be used with various wheel rim designs.

Both the torque and combined steer/camber moment load ratings of the *TW15.0 transducer* are 7000 lb-ft. High grade stainless steel material and weatherproof sealing combine to provide excellent resistance to corrosion and environmental conditions. Temperature compensation ensures stable output throughout a wide temperature range. In addition, all wires are precisely located to reduce sensitivity to magnetic effects.

Specifications

Maximum Load Capacity	7000 lb-ft (9492 N-m)
Full Scale Load	7000 lb-ft (9492 N-m)
Full Scale Output	1.5mV/V nominal
Sensor	4 arm strain-gage bridge
Nonlinearity	0.1% of full scale output
Hysteresis	0.05% of full scale output
Bridge Resistance	525 Ω nominal
Temperature Range, Compensated	75°F to 250°F (24°C to 121°C)
Temperature Effect on Zero	0.0008% full scale/ °F (0.0015% full scale/ °C)
Temperature Range, Useable (Short Term)	-40°F to 350°F (-40°C to 177°C)
Temperature Range, Useable (Long Term)	-40°F to 300°F (-40°C to 149°C)
Excitation Voltage, Maximum	10V DC or AC rms
Insulation Resistance, Bridge/Case	Exceeds 5000 M Ω
Output Connector	Bendix PTY02E-8-4P
Mating Connector	Bendix PT06E-8-4S (SR)

European representative :

PM Instrumentation

59 Rue Emile Deschanel, 92400
Courbevoie, France
Phone + 33(0)1 46 91 93 32

rev. A

MICHIGAN SCIENTIFIC
corporation

<http://www.pm-instrumentation.eu>
<http://www.michsci.com>

contact : contact@pm-instrumentation.eu

Wheel Torque Transducer

TW15.0 Configuration

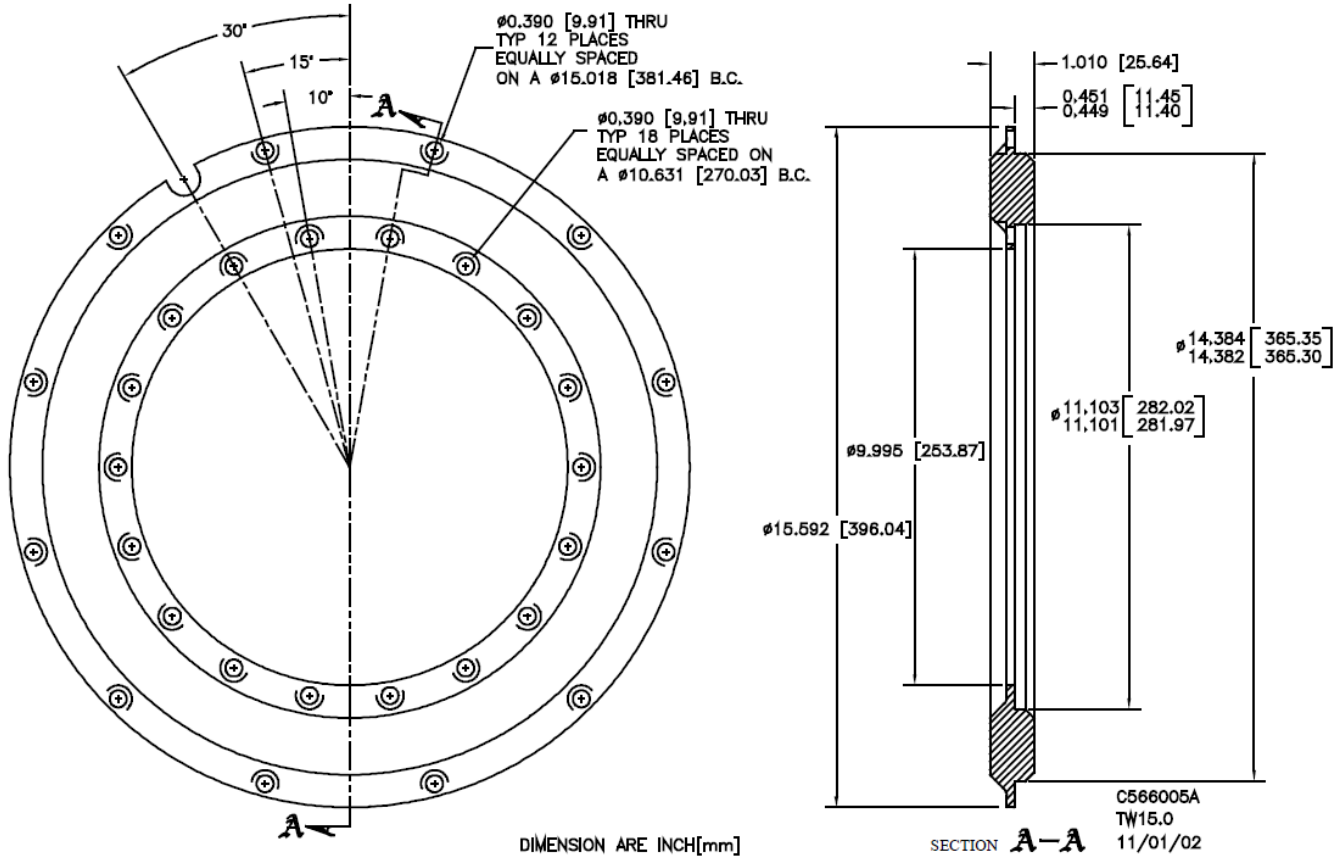

Ordering Options

Special units are available for high temperature applications.

Custom designs with alternative output sensitivities and load capacities may also be ordered.

Michigan Scientific offers a fully weatherproof slip ring, encoder, and amplifier instrumentation assembly to be used with all Wheel Torque Transducers. Refer to the product literature section Instrumentation Assemblies "Instrumentation Assemblies" for more information.

European representative :

PM Instrumentation
59 Rue Emile Deschanel, 92400
Courbevoie, France
Phone + 33(0)1 46 91 93 32

rev. A

MICHIGAN SCIENTIFIC
corporation

<http://www.pm-instrumentation.eu>
<http://www.michsci.com>
contact : contact@pm-instrumentation.eu